

## MILANO Vitrine

Designer: SBGA | Blengini Ghirardelli  
Year: 2019



### DESCRIPTION

Milano collection vitrine with 2 glass doors. Wooden structure, gloss polyester finish glossy white rose color lacquered. Laether application. Brushed nickel metal legs and details. More wooden finishes and leather application are available in our samples books.

### DRAWINGS

measures in cm and inch

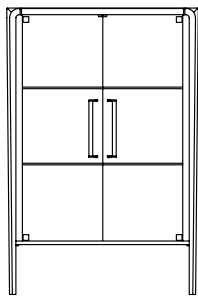

100  
39 <sup>3</sup>/<sub>8</sub>

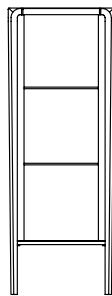

55  
21 <sup>21</sup>/<sub>32</sub>

150  
59 <sup>1</sup>/<sub>16</sub>

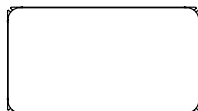

55  
21 <sup>21</sup>/<sub>32</sub>