

FRAME

Mobile contenitore con struttura in acero disponibile in due finiture: grigio tortora (fin.2B) e grigio ardesia (fin.2C). Il profilo laterale è rivestito in cuoio. Nella parte superiore sono presenti due piani estraibili in legno con fondo in marmo, nelle varianti Calacatta oro, Portoro, Zebrino o in cuoio. I due piani estraibili sono dotati di illuminazione LED con sensore di accensione e spegnimento a movimento. Il lato destro presenta tre cassetti con maniglie ad incasso ed interno in Sycamore frisè, dotati di guide scorrevoli a scomparsa ad estrazione totale, con sistema di chiusura silent system. Sul lato sinistro le due ante, con maniglie ad incasso ed interno in tinta con la struttura esterna ospitano un ripiano in cristallo grigio. Il basamento è regolabile per il livellamento

Cabinet with maple wood structure available in two finishes: dove gray (fin.2B) and slate gray (fin.2C). The lateral profile is covered with saddle leather. In the upper part, there are two removable wooden shelves with marble bottom, available in Calacatta gold, Portoro, Zebrino or saddle leather. The two removable shelves are equipped with LED lighting with with a motion switching on and off sensor. The right side has three drawers with recessed handles and internal parts in Fiddleback Sycamore, equipped with an internal one on the left, all completely removable with recessed sliding runners. The two doors on the left side, with recessed handles and the interior in the same color as the external structure, contain a gray crystal shelf. The base is adjustable for levelling.

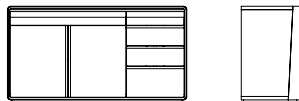

59400

Mobile contenitore in acero e cuoio con piani estraibili illuminati in cuoio, ante e cassetti

Cabinet in maple wood and saddle leather with illuminated removable wooden shelves with saddle leather bottom, with drawers and doors

cm 157 x 52 x h 86
in 61 7/8 x 20 1/2 x h 33 7/8

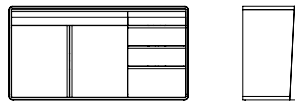

59401

Mobile contenitore in acero e cuoio con piani estraibili illuminati in marmo, ante e cassetti

Cabinet in maple wood and saddle leather with illuminated removable wooden shelves with marble bottom, with drawers and doors

cm 157 x 52 x h 86
in 61 7/8 x 20 1/2 x h 33 7/8

2B

2C



1 Frame 59401 saddle leather tobacco fin.2B



2 Frame 59400 saddle leather dove-grey fin.2B