

KESSLER SIDEBOARD

MAURO LIPPARINI



Much more than a simple piece of furniture: subtle storage pieces that deliver contemporary simplicity. **Kessler's** distinguishing feature is the sleek legs that support the imposing main section. The front panels are available in different materials and/or finishes, which represents a further note of aesthetic contrast.

TYPE / SIDEBOARDS

TECHNICAL DESCRIPTION

Series of sideboards with fixed designs available in three types: wall mounted units / two-sided units / hanging.

The two-sided version with fixed back panel in the same finish as the top.

Top 3 sided frame th.6 mm finish in veneer wood, matt lacquer or glossy lacquer.

Hinged or flap doors in transparent or reflecting glass.

Hinged or flap doors in wood finish: veneer wood, matt lacquer or glossy lacquer.

Internal finish in melamine or matt lacquer.

Internal shelves in melamine or internal glass shelves th.8mm.

Base and handle in gun metal finish.

Kessler 01: hinged glass doors and sided frame in wood (available double-sided).

Kessler 02: down flap and hinged doors in wood (available double-sided).

Kessler 03: hinged glass doors and sided frame in glass.

Kessler 04: down flap doors in glass (available double-sided).

Kessler 05: down flap doors, hinged doors in wood (available double-sided).

Kessler 06: hanging sideboard with flap doors and hinged doors in wood.



DESIGNER

MAURO LIPPARINI

Mauro Lipparini earned a degree in Architecture in 1980 from Università degli Studi of Florence, where he also worked as a professor. He won the international design contests Young & Designer Milan (1987) and International Du Pont Award Köln (Germany, 1988 and 1989). Lipparini's intense activity in the field of industrial design covers office and home furniture, the textile industry and other products created for many companies in Europe and Japan. In architecture and interior design, Lipparini has concentrated mainly on private and public housing, on showrooms, retail sales outlets and exposition installations. Furthermore, Lipparini also designs and realizes advanced corporate identity image systems that range from graphics to editorial services to production. Lipparini's style is based on the essential shapes and the clear and decisive lines that are characteristic of natural minimalism. His creations are imbued with a joyful spirit and with an elating sense of aesthetic pleasure and creativity. Thanks to his free use of color, organic weave patterns and original visual ideas, Lipparini amplifies the palette of minimalism, conveying the spontaneity and power of this aesthetic style and projecting it towards a new era of great maturity and wellbeing.



3 SIDED TOP FINISHINGS

MATT LACQUERED COLOURS



HIGH GLOSS LACQUERED COLORS





L98 Oliva



L8S Giallo



L9B Senape



L94 Marsala



L81 Fuoco



L95 Ruggine



L9H Petrolio



L9E Deep
Blu

MATT VENEERS



53 Olmo
grey



50 Rovere
cenere



52 Rovere
fumé



51 Oak
Black

INNER FINISHINGS

MATT LACQUERED COLOURS



01 Gesso

8B Caolino

9G Ostrica

6B Grigio
Pietra

14 Nero

02 Talco

9F Sand

4G Argilla



8C
Cappuccino

5B Grigio
Lava

72 Sabbia

8A Beige

9T Toffee

93 Melange

13 Sepia

09 Wengè



98 Oliva

8S Giallo

9B Senape

94 Marsala

81 Fuoco

95 Ruggine

9H Petrolio

9E Deep Blu



04 Bronzo

96 Canna di
Fucile

99 Titanio

10 Argento

07 Ottone

05 Dark
Bronze

06 Graphite

MELAMINE



877
Ambience

DOOR FINISHINGS

MATT LACQUERED COLOURS



HIGH GLOSS LACQUERED COLORS



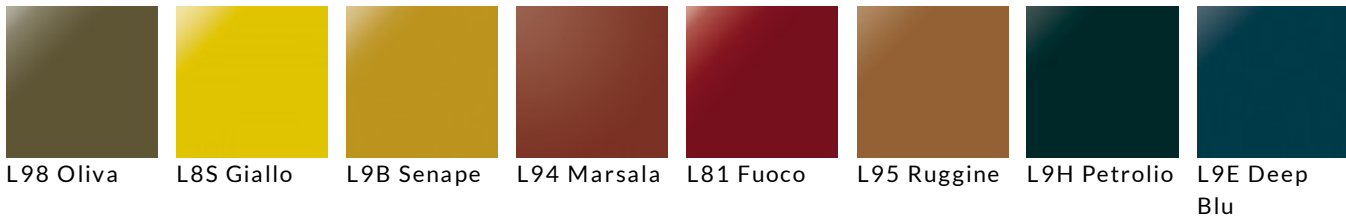

TRANSPARENT GLASS

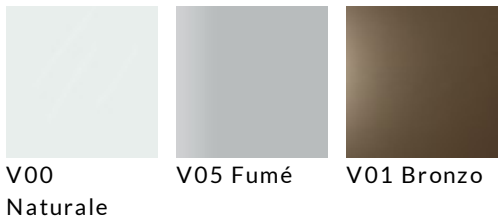

REFLECTING GLASS

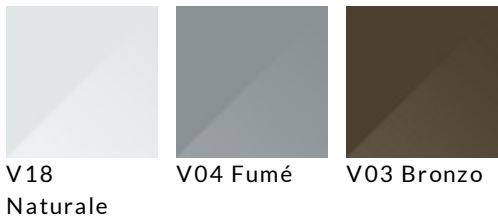

MATT VENEERS



SHELF FINISHINGS

MATT LACQUERED COLOURS



TRANSPARENT GLASS

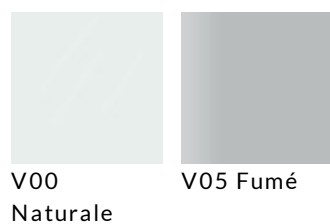

MELAMINE

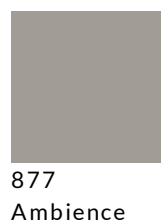

BASE AND HANDLE FINISHINGS

METALS



524
Verniciato
Canna di
fucile

DIMENSIONS

Kessler 01

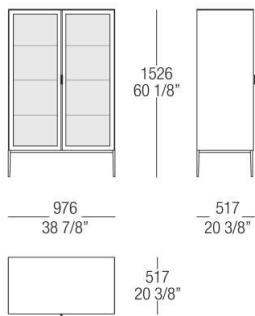

Kessler 02

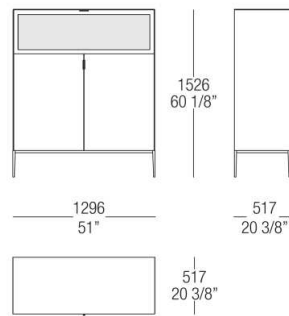

Kessler 03

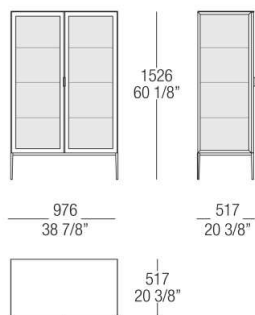

Kessler 04

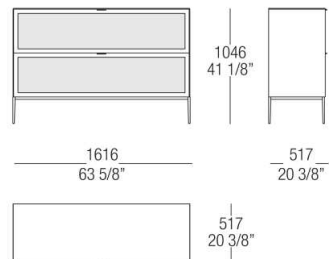

Kessler 05

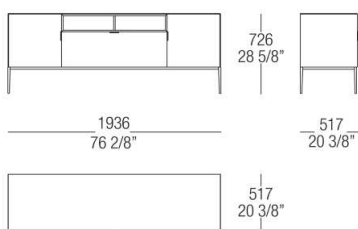

Kessler 06

