

LAVABI DA APPOGGIO | COUNTERTOP WASHBASINS

| AUFSATZBECKEN | VASQUES À POSER | LAVABOS DE APOYO

LAVABO DA APPOGGIO IN CRISTALPLANT / COUNTERTOP BASIN IN CRISTALPLANT / AUFSATZWASCHBECKEN AUS CRISTALPLANT / VASQUE À POSER EN CRISTAL PLANT / LAVABO DE APOYO EN CRISTALPLANT

ECCENTRICO



Art.	L	P	H
WN1	56	56	14

Accessori compresi / Included accessories

Piletta / Waste Art. 54G	Copri piletta in finitura / Drain cover in finish Cristalplant	Troppo pieno / Overflow No
-----------------------------	-------------------------------------------------------------------	-------------------------------

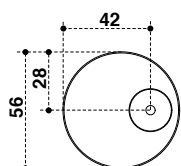
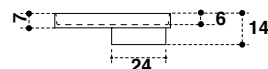

N.B. fissaggio al top del mobile tramite viti / Remark: fixing to the cabinet top with screws / Anmerkung: Befestigung zur Möbeltopplatte durch Schrauben / Attention : fixation au top du meuble avec des vis. / Nota: fijación a la encimera del armario con tornillos

LAVABO DA APPOGGIO IN MARMO / COUNTERTOP BASIN IN MARBLE / AUFSATZ WASHBECKEN AUS MARMOR / VASQUE À POSER EN MARBRE / LAVABO DE APOYO EN MARMOL

ECCENTRICO



Art.	L	P	H
WN3	56	56	14

Accessori compresi / Included accessories

Piletta / Waste Art. 54G	Copri piletta in finitura / Drain cover in finish Marmo / Marble	Troppo pieno / Overflow No
-----------------------------	---------------------------------------------------------------------	-------------------------------

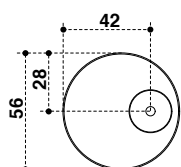
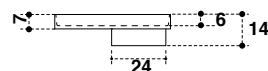

N.B. fissaggio al top del mobile tramite viti / Remark: fixing to the cabinet top with screws / Anmerkung: Befestigung zur Möbeltopplatte durch Schrauben / Attention : fixation au top du meuble avec des vis. / Nota: fijación a la encimera del armario con tornillos

MARMI 1 / MARBLES 1



MC

Carrara
Carrara



MI

Pietra Grey
Grey Stone



MQ

Nero Marquina
Nero Marquina

Marmi in finitura satinata opaca.
Marble feasible in satin matt finish.
Marmor in satiniert matter Ausführung
Marbre en finition matte satinée.
Mármol en un acabado mate satinado.

MARMI 2 / MARBLES 2



MR

Statuario
Statuary



MP

Calacatta Gold
Calacatta Gold

LAVABI DA TERRA | FREESTANDING BASINS

| FREISTEHENDE WASHBECKEN | LAVABOS À COLONNE | LAVABO EN COLUMNA

LAVABO FREESTANDING IN CRISTALPLANT BIOBASED E LEGNO / CRISTALPLANT BIOBASED AND WOOD FREESTANDING WASHBASIN / FREISTEHENDES WASHBECKEN AUS CRISTALPLANT BIOBASED UND HOLZ / LAVABO SUR PIED EN CRISTALPLANT BIOBASED ET BOIS / LAVABO FREESTANDING EN CRISTALPLANT BIOBASED Y MADERA

ECCENTRICO



Art.	L	P	H
WN5	63	56	90

Accessori compresi / Included accessories

Piletta / Waste	Copri piletta in finitura / Drain cover in finish	Troppo pieno / Overflow
Art. 54G	Cristalplant	No

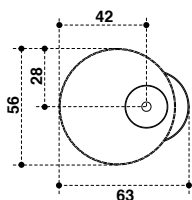
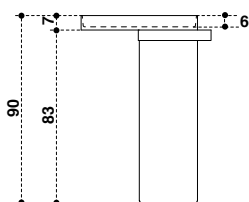

■ **Indicare le finiture del porta salviette e del basamento.** / Specify the finish of the towel bar and base. / Die gewünschte Farbe des Handtuchhalters und Säule angeben. / Spécifier la finition du porte-serviette et de la base. / Especificque el acabado del porta pañuelos y base.

FINITURE PORTA SALVIETTE / TOWEL BAR FINISHES / OBERFLÄCHE DES HANDTUCHHALTERS / FINITION DU PORTE-SERVIETTE / ACABADOS DEL SUPORTE PORTA PAÑUELOS

**METALLI
METALS**



TI
Inox Titanium
Stainless steel titanium



RM
Rame spazzolato
Brushed copper



OR
Ottone spazzolato
Brushed brass



ON
Onice
Onyx

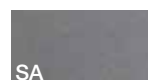

SA
Inox satinato
Satin stainless steel

FINITURE BASAMENTO / BASE FINISHES / OBERFLÄCHE DER SÄULE / FINITION DE LA BASE / ACABADOS BASE

**LEGNI
WOODS**



Realizzabile in tutte le finiture legno della Cat. 2.
Feasible in all the Cat. 2 wood finishes.
Herstellbar in allen Holzfarben (Cat. 2)
Réalizable en toutes les finition bois de la Cat. 2.
Factible en todos los acabados madera (Cat. 2).



AA Acacia TH
Acacia TH
Akazie TH
Acacia TH
Acacia TH

LAVABI DA TERRA | FREESTANDING BASINS

| FREISTEHENDE WASCHBECKEN | LAVABOS À COLONNE | LAVABO EN COLUMNA

LAVABO FREESTANDING IN MARMO E LEGNO / MARBLE AND WOOD FREESTANDING WASHBASIN / FREISTEHENDES WASCHBECKEN AUS MARMOR UND HOLZ / LAVABO SUR PIED EN MARBRE ET BOIS / LAVABO FREESTANDING EN MARMOL Y MADERA

ECCENTRICO

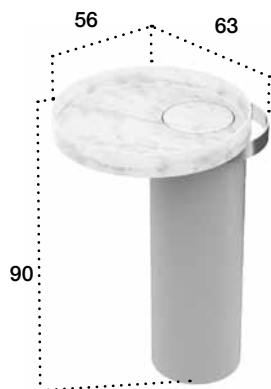

Art.	L	P	H
WN7	63	56	90

Accessori compresi / Included accessories

Piletta / Waste Art. 54G	Copri piletta in finitura / Drain cover in finish Marmo / Marble	Troppo pieno / Overflow No
-----------------------------	---------------------------------------------------------------------	-------------------------------

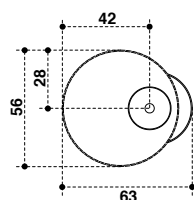
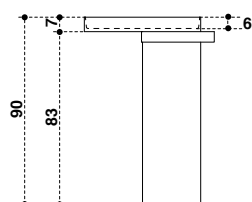

■ **Indicare le finiture del lavabo, del porta salviette e del basamento.** / Specify the finish of the towel bar, basin and base. / Die gewünschte Farbe des Handtuchhalters, Waschbeckens und Säule angeben / Spécifier la finition du lavabo, du porte-serviette et de la base. / Especificar el acabado del porta pañuelos, lavabo y base.

FINITURE LAVABO / BASIN FINISHES / OBERFLÄCHE DES WASCHBECKENS / FINITION DU LAVABO / ACABADOS DE LAVABO

MARMI 1
MARBLES 1



MC
Carrara
Carrara



MI
Pietra Grey
Grey Stone



MQ
Nero Marquina
Nero Marquina

Marmi in finitura satinata opaca.
Marble feasible in satin matt finish.
Marmor in satinierter matter Ausführung
Marbre en finition mate satinée.
Mármol en un acabado mate satinado.

MARMI 2
MARBLES 2



MR
Statuario
Statuary



MP
Calacatta Gold
Calacatta Gold

FINITURE PORTA SALVIETTE / TOWEL BAR FINISHES / OBERFLÄCHE DES HANDTUCHHALTERS / FINITION DU PORTE-SERVIETTE / ACABADOS DEL SUPORTE PORTA PAÑUELOS

METALLI
METALS



TI
Inox Titanium
Stainless steel titanium



RM
Rame spazzolato
Brushed copper



OR
Ottone spazzolato
Brushed brass



ON
Onice
Onyx



SA
Inox satinato
Satin stainless steel

FINITURE BASAMENTO / BASE FINISHES / OBERFLÄCHE DER SÄULE / FINITION DE LA BASE / ACABADOS BASE

LEGGI
WOODS



Realizzabile in tutte le finiture legno della Cat. 2.
Feasible in all the Cat. 2 wood finishes.
Herstellbar in allen Holzfarben (Cat. 2)
Réalizable en toutes les finitions bois de la Cat. 2.
Factible en todos los acabados madera (Cat. 2).



AA Acacia TH
Acacia TH
Akazie TH
Acacia TH
Acacia TH